

   **TOP END**®



## Invacare® Top End® Excelerator™ Series Handcycles

If you want a great way to exercise, cross-train or just have fun, one of the **Invacare® Top End® Excelerator™ Series Handcycles** is just what you need. This upright and extremely maneuverable three-wheel handcycle is capable of speeds up to 15 mph. The smooth Shimano® hub with its reversing drum brake delivers hands-on braking and allows the rider to tackle hills or level terrain with equal ease. The oval tube carbon steel frame construction with adjustable sliding seat makes transfers in and out easier too. There are two great models to choose from: the stocked model can be shipped right away and the custom model allows you to choose your favorite color and seat width.

The Excelerator Handcycle offers some great options too. You can order the popular mountain drive option which adds 7 extra low gears for climbing hills or the V crankset option with its wider cranks to allow more clearance for those who are tall or require additional space. No excuses...Get Cranking! Check out our childrens' models too!



### Invacare Top End Excelerator Features

Carbon steel frame and fork  
Adjustable seat: forwards and backwards  
Adjustable back height  
Fold over back upholstery  
Adjustable crank height  
Chain tension idler  
Reflectors and safety flag  
Adjustable height/angle footrest system  
Shimano® internal hub with reversing drum brake

Parking brake  
Single chain ring  
Ovalized ergonomic hand pedals  
Performance wheels with cruiser tires  
Quick release axles  
3° camber  
Cushion and hook and loop seat restraint  
Weight capacity 350 lb.

### Model #: XCL/XCLSTK

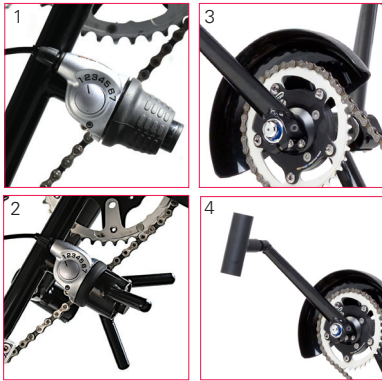

1. Twist Shifter for 7 speed hub
2. Quad Twist shifter option
3. Mountain drive transmission option
4. Frictionless ovalized handpedals



### Options

Crank width adapter set  
Mountain drive transmission adds 7 low gears  
Quad twist shifter helps those with hand impairments  
Tri-pin quad handpedals  
QuadGrip handpedals with 3" width extensions  
Water bottle and cage  
Tow bar for wheelchair  
Cordless computer

Front safety light  
Rear flashing light  
Helmet  
Seat restraint: Auto style fastener  
Mirror  
Crutch holder and strap  
Bike rack for trailer hitch  
Top End t-shirt

**The Invacare® Top End® Li'l Excelerator™ and Invacare® Top End® Li'l Excelerator™-2 are sized just right for children and are available in 7 speeds and 3 speeds, respectively.**

**Invacare Top End Li'l Excelerator-2 Features**

Aluminum frame and transport ready fork  
 Adjustable seat: forwards and backwards  
 Adjustable back height  
 Adjustable tension back upholstery  
 Adjustable crank height  
 Chain tension idler  
 Chain guard, reflectors and safety flag  
 Adjustable height/angle footrest system  
 Shimano® 3 speed hub with reversing drum brake

Locking parking brake  
 153 mm crankset with one chain ring  
 Ergonomic handpedals  
 20" Cruiser wheels and tires  
 Quick release axles  
 9° camber  
 Cushion and hook and loop seat restraint  
 Candy Apple Red paint  
 Weight capacity 175 lb.



Li'l Excelerator-2 - Handcycle



**Model #: LXC2H  
 Candy Apple Red**

- 1. Parking brake
- 2. Ergonomic handpedals
- 3. Hook and loop safety seat restraint

**Invacare Top End Li'l Excelerator Features**

Carbon steel frame and fork  
 Adjustable seat: forwards and backwards  
 Adjustable back height  
 Fold over back upholstery  
 Adjustable crank height  
 Chain tension idler  
 Full chain guard, reflectors and safety flag  
 Adjustable height/angle footrest system  
 Shimano® 7 speed hub with reversing drum brake  
 Parking brake  
 155 mm crankset with one chain ring  
 Ergonomic handpedals

20" Cruiser wheels and tires  
 Quick release axles  
 9° camber  
 Cushion and hook and loop seat restraint  
 Choice of 11 colors  
 Weight capacity 250 lb.



**Model #: LXC  
 Royal Blue**

**Options for LXC2H and LXC**

Foam covered horizontal handpedals  
 Quad twist shifter option  
 Mirror

Water bottle and cage  
 Helmet  
 Front safety light  
 Rear flashing light

Crutch holder and strap  
 Bike rack for trailer hitch  
 Seat restraint: Auto style fastener

**Optional upgrades:**



1. V Crankset - Only available on custom XCL

The Invacare® Top End® V crankset option accommodates consumers who might have “clearance” issues. Only available on the Invacare Top End Custom Excelerator Handcycle.

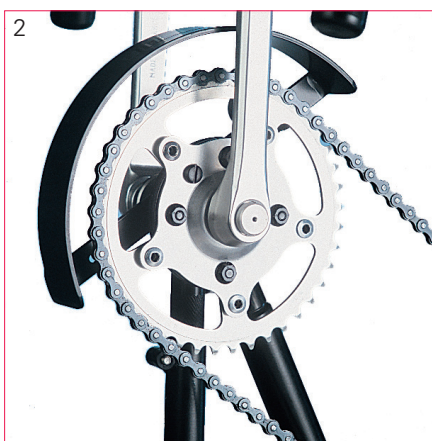

2. Mountain Drive Transmission (Only available on custom)

Available on the Excelerator handcycle  
Adds 7 low gears (7 low + 7 standard = 14 total)  
Easy shifting, especially for quadriplegics – just push in the center button  
Lightweight planetary transmission  
A must-have for hilly terrain



3. QuadGrip Handpedals

QuadGrip handpedals with 3” width extensions and QuadWraps are a great option for those with limited hand function. Add the Quad twist shifter option and the mountain drive for optimal function and fun.

**Invacare Corporation**  
www.invacare.com

**USA**

One Invacare Way  
Elyria, Ohio  
44035-4190  
(800) 333-6900

**Canada**

570 Matheson Blvd. E.,  
Unit 8  
Mississauga, Ontario  
L4Z 4G4 Canada  
(800) 668-5324

**Top End**

www.topendwheelchair.com  
Sports and Recreation  
Products  
4501 63rd Circle North  
Pinellas Park, Florida  
33781-5914  
(800) 532-8677  
Fax: (727) 522-1007

©2018  
Invacare Corporation.  
All rights reserved.  
Trademarks are identified  
by the symbols ™ and ®.  
All trademarks are owned  
by or licensed to Invacare  
Corporation unless  
otherwise noted.  
Shimano is a registered  
trademark of Shimano  
Inc. Specifications are  
subject to change without  
notification.  
Form No. 18-175  
180733

